

CALIBURN ALUMILAN ASSEMBLY INSTRUCTIONS

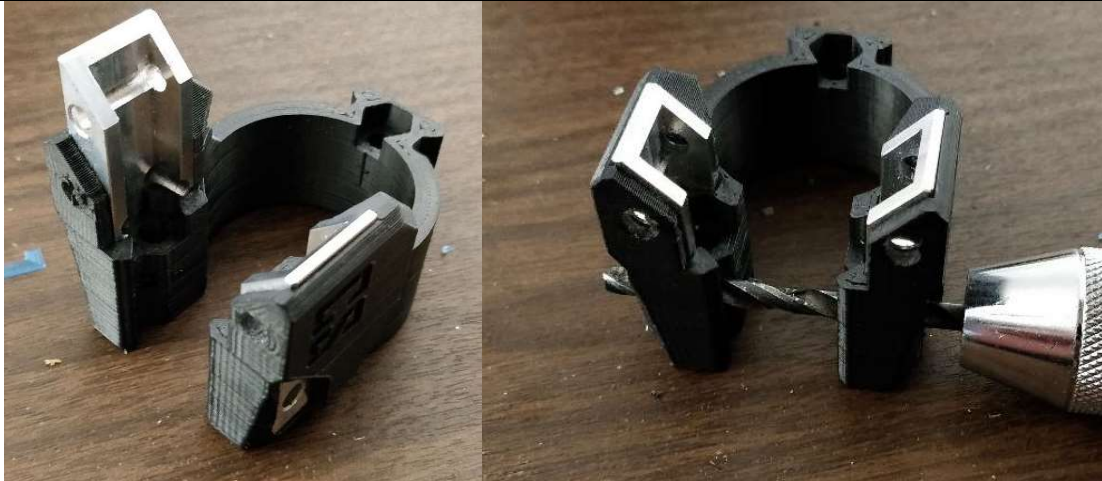

After printing "Milan_Coupler_B", slide an insert into each side from the front.

With a 3/16" drill bit, use a SLOW power drill or hand drill to drill out the rear/lower pair of holes in the print starting from the hole in either insert.

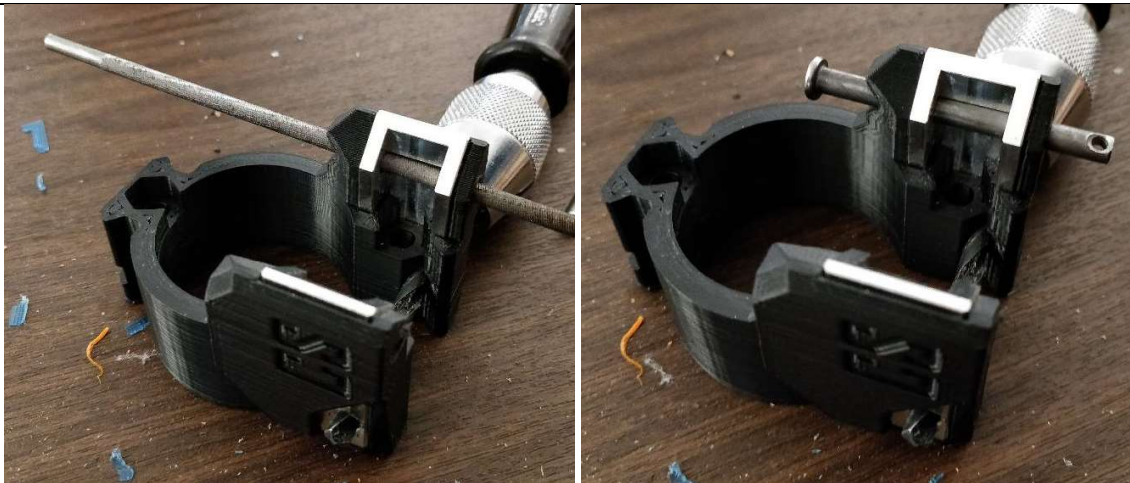

Use a NEEDLE FILE (NOT a drill) to clean up the holes in the print until they line up perfectly with the holes in the insert.

Test-fit the filed hole with a takedown pin (3/16" OD x 2" Length). If it fits too tightly, file out the holes in the print a little more.

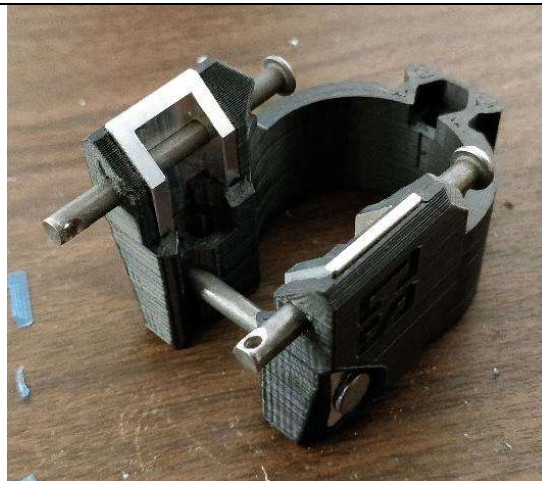

Repeat for the other side using a NEEDLE FILE again. Once a takedown pin can be easily inserted or removed from every hole in the assembly, you are ready to install it on the blaster.